



To take advantage of the SMARTMAG technology, it is important that you read and understand this manual.

Always consult a professional when in doubt regarding the SMARTMAG functions.

This manual is intended only as an instruction regarding our SMARTMAGs and SMART-FOLLOWERS and cannot substitute real training and professional instruction.

Different types of ammunition can be used for live training. Always be aware of proper use of the weapon itself and the ammunition.

To minimize the risks, always be sure to have the proper training, always use ammunition and weapons according to the correct range safety practices.

MAKE SURE YOU FOLLOW THE FIVE PRIMARY RULES OF FIREARMS SAFETY

Failing to do so may result in serious injury or death.

SMARTMAG ApS can not be held responsible for injury, death or property damage resulting from faulty installation, misuse, illegal use or modifications.

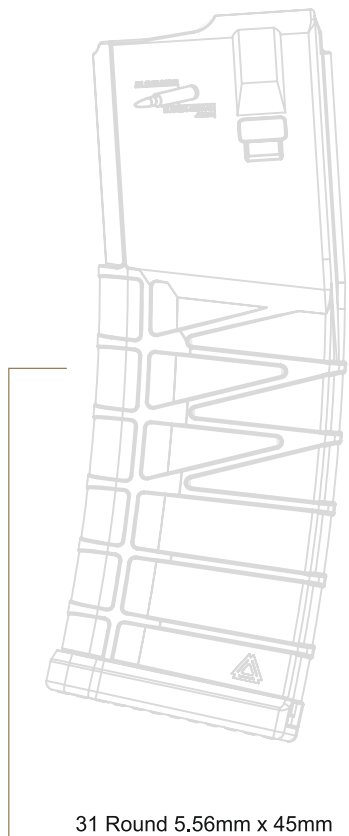

31 Round 5.56mm x 45mm

LOADING MAGAZINE



Set the cartridge on the follower and press it straight down until the magazine lips holds the cartridge in place.

Note: A «bullet» on the follower shows the correct cartridge direction.



Position the Magazine corner to corner within the well..



..push the Magazine upwards in a straight line..



..until you hear/feel a click, then give the Magazine a firm push to insure it locks in place.

Note: Never slab the magazine in place, this may result in damages on the weapon or damage the lips on top of the magazine.

LOOK AND RELEASE



When the bolt stop engages, set **safety on**.

Note: When the bolt stop engages, 1 round is left in the magazine.

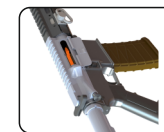

Look into ejector port ..

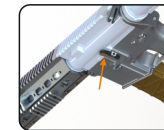

..and release bolt. This will chamber the last round.

Note: Since the last round is now chambered, the weapon is now locked and loaded.



Eject magazine.



Insert magazine.

You are now back in the fight.



SMARTMAG
INNOVATIVE TACTICAL PERFORMANCE

The R6 SMARTMAG can be converted to the standard function simply by turning and re-inserting the Bolt stop engager upside-down.

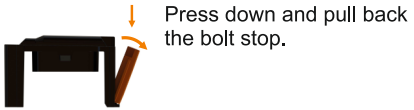

Press down and pull back the bolt stop.

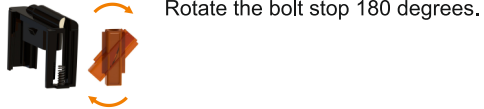

Rotate the bolt stop 180 degrees.

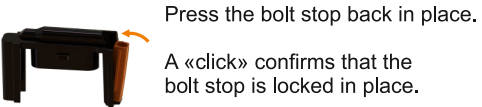

Press the bolt stop back in place.

A «click» confirms that the bolt stop is locked in place.

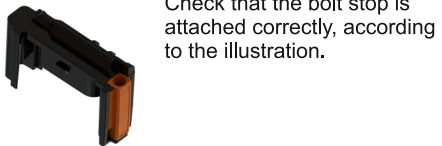

Check that the bolt stop is attached correctly, according to the illustration.

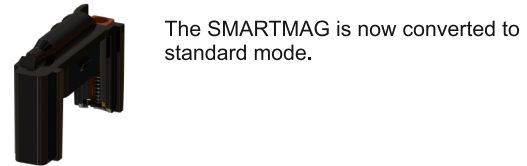

The SMARTMAG is now converted to standard mode.

+1 Round Reload®



The SMARTMAG Follower will engage the bolt catch, when one round is left in the magazine.

Thereby letting you chamber that last round, before changing mags.

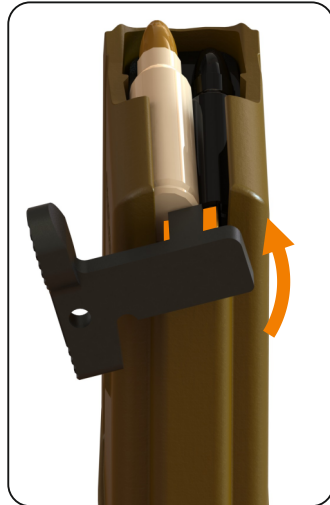

The five primary rules of firearms Safety

1. All firearms are always loaded, Period!
2. Never point a firearm at anything you are not willing to destroy.
3. Always be sure of your target, foreground and background.
4. Keep your fingers of the trigger until you are on target and ready to shoot!
5. Always safely unload your firearm at the end of each use.